

**Product Facts**

- User configurable high voltage connector
- Cost effective, 6-position
- Operating voltage: 5,000 volts DC
- Operating current: 3 Amps max.
- Quick-turn threaded coupling
- Accepts Type XI size 20 contacts

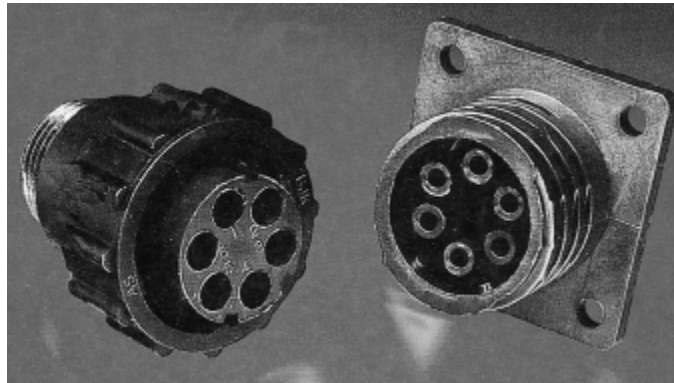

A cost-effective approach in a plastic circular connector with crimp snap-in contacts. Wherever high voltage is required, this user friendly configuration can operate up to 5,000 volts DC.

This 6 position connector can be selectively loaded for various high voltage applications such as:

- Materials Handling Equipment
- Medical Equipment
- Computer and Peripheral Equipment
- HV Power Supplies
- Automated Manufacturing Equipment
- Test Equipment

This LGH connector offers an economical solution for your high voltage requirements. This quick-turn coupling connector will also accommodate standard Tyco Electronics Circular Plastic Connector backshell accessories.

**Material and Mechanical Characteristics**

Housings — UL 94V-0  
 Operating Temperature —  
 -5°F to 185°F [-15° C to 85° C]

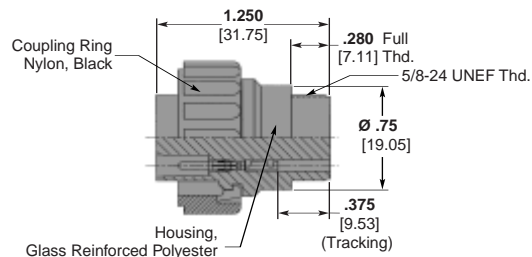
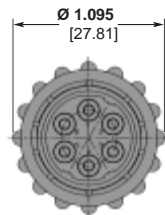

**Part Number 867534-1**

Accepts Pin Contact  
 Part Number 203816-6 for 20-24 AWG wire  
 (Not Supplied with Plug Kit)

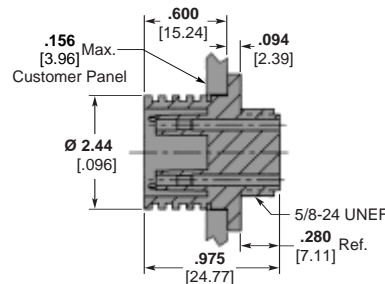
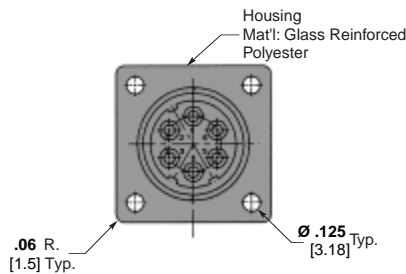

**Part Number 867535-1**

Accepts Socket Contact  
 Part Number 203802-6 for 20-24 AWG wire  
 (Not Supplied with Receptacle)

