

## ZRS TYPE

### FEATURES

The ZRS type features deep grooves which permit improved cooling by ensuring that the entire core is optimally cooled.

### CAUTION

Please take care to only use an impeder case with an appropriate internal diameter.

The smaller impeder case of recommended internal diameter may occur not to be inserted the impeder core.

Before using this product, please note that it is not guaranteed for use as anything other than an impeder.

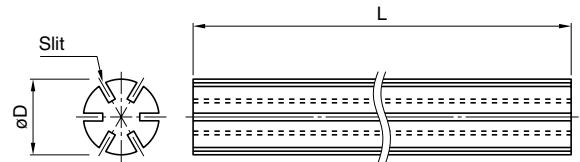

Dimensions in mm

Part No. (D×L)	External diameter D	Length L	Number of slit	Lengthwise structure	Recommended internal diameter of impeder case
IPH ZRS5×200	5±0.25	200±3.0	6	One piece	6
IPH ZRS6×200	6±0.25	200±3.0	6	One piece	7
IPH ZRS7×200	7±0.25	200±3.0	6	One piece	8
IPH ZRS8×200	8±0.25	200±3.0	6	One piece	9
IPH ZRS9×200	9±0.30	200±3.0	6	One piece	10
IPH ZRS10×200	10±0.30	200±3.0	8	One piece	11
IPH ZRS11×200	11±0.35	200±3.0	8	One piece	12
IPH ZRS12×200	12±0.35	200±3.0	8	One piece	13
IPH ZRS13×200	13±0.40	200±3.0	8	One piece	14
IPH ZRS14×200	14±0.40	200±3.0	8	One piece	15
IPH ZRS15×200	15±0.45	200±3.0	8	One piece	16
IPH ZRS16×200	16±0.50	200±3.0	8	One piece	17
IPH ZRS17×200	17±0.50	200±3.0	8	One piece	18
IPH ZRS18×200	18±0.55	200±3.0	8	One piece	19
IPH ZRS19×200	19±0.55	200±3.0	8	One piece	20
IPH ZRS20×200	20±0.60	200±3.0	8	One piece	21
IPH ZRS21×200	21±0.60	200±3.0	8	One piece	22
IPH ZRS22×200	22±0.55	200±3.0	8	8 pieces joined	23
IPH ZRS23×200	23±0.60	200±3.0	8	8 pieces joined	24
IPH ZRS24×200	24±0.60	200±3.0	8	8 pieces joined	25
IPH ZRS25×200	25±0.65	200±3.0	8	8 pieces joined	26
IPH ZRS30×200	30±0.75	200±3.0	8	8 pieces joined	31

### PRODUCT IDENTIFICATION

$$\frac{\text{IPH}}{(1)} \frac{\text{ZRS}}{(2)} \frac{10}{(3)} \times \frac{200}{(4)}$$

- (1) Material
- (2) Shape
- (3) External diameter D
- (4) Length L